

Soils Map

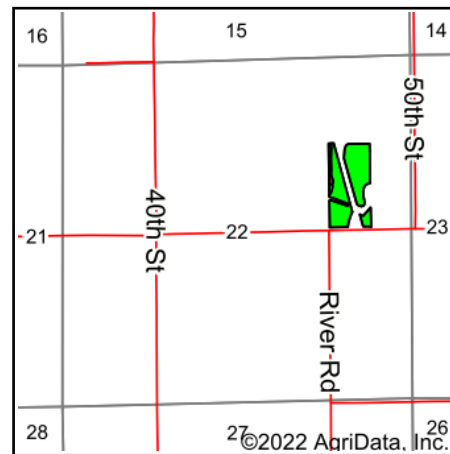

Soils data provided by USDA and NRCS.



State: **Iowa**
 County: **Poweshiek**
 Location: **22-78N-16W**
 Township: **Sugar Creek**
 Acres: **13.41**
 Date: **5/6/2022**



Maps Provided By:



Area Symbol: IA157, Soil Area Version: 25

Code	Soil Description	Acres	Percent of field	CSR2 Legend	Non-Irr Class *c	CSR2**	CSR
220	Nodaway silt loam, shallow loess, 0 to 2 percent slopes, occasionally flooded	12.70	94.7%		Ilw	77	85
65E	Lindley loam, 14 to 18 percent slopes	0.38	2.8%		Vle	31	30
993E2	Gara-Armstrong loams, 14 to 18 percent slopes, moderately eroded	0.20	1.5%		Vle	24	5
11B	Colo-Ely complex, 0 to 5 percent slopes	0.13	1.0%		Ilw	86	68
Weighted Average					2.17	75	82.1

**IA has updated the CSR values for each county to CSR2.

*c: Using Capabilities Class Dominant Condition Aggregation Method

Soils data provided by USDA and NRCS.